

INSTRUCTIONS ON HOW TO CREATE A CORRECT FILE FOR CUSTOMISABLE PAPER NAPKINS

The following instructions are designed to help you create a correct printing file. If still in doubt, please download the template, visit FAQ on our website, activate the File Verification with an operator, call our Customer Service or contact us via email or through a chat.

1 FILE FORMAT

Our systems only process PDF format files on 1:1 scale - without password.

2 COLOURS

Colours may slightly differ due to the composition of the fabric on which they are printed. In all files assign black colour to your artwork. Irrespective of this, napkins will be printed in the colour chosen by you in the order.

3 RESOLUTION

The best resolution is between 250dpi and 300dpi.

4 PRINTING INSTRUCTIONS

Napkins are printed in flexography, in one colour and on one side. Only one part of the napkin may be personalised, and not the entire area (see "Printing area for more information")

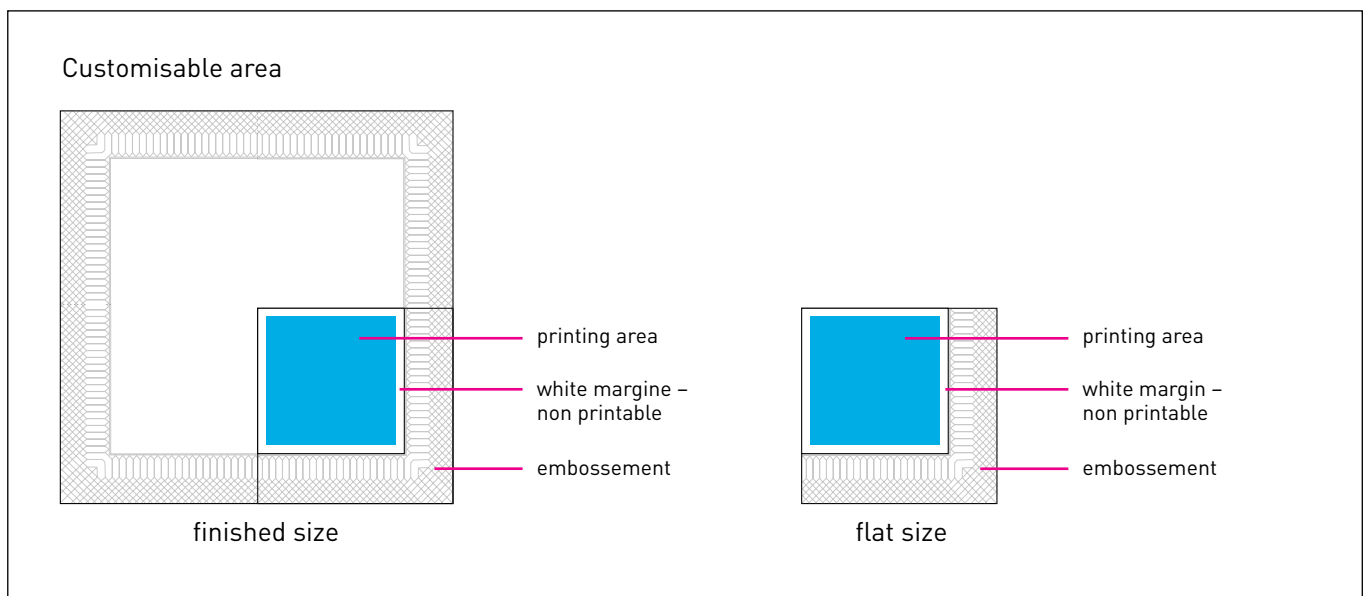

Your artwork will always be printed in such way that embossed areas are at the lower right side and from left to right. Depending on your desired final result, you can rotate your graphic. These rules are also valid for Airlaid napkins, with the only difference that there is no embossment.

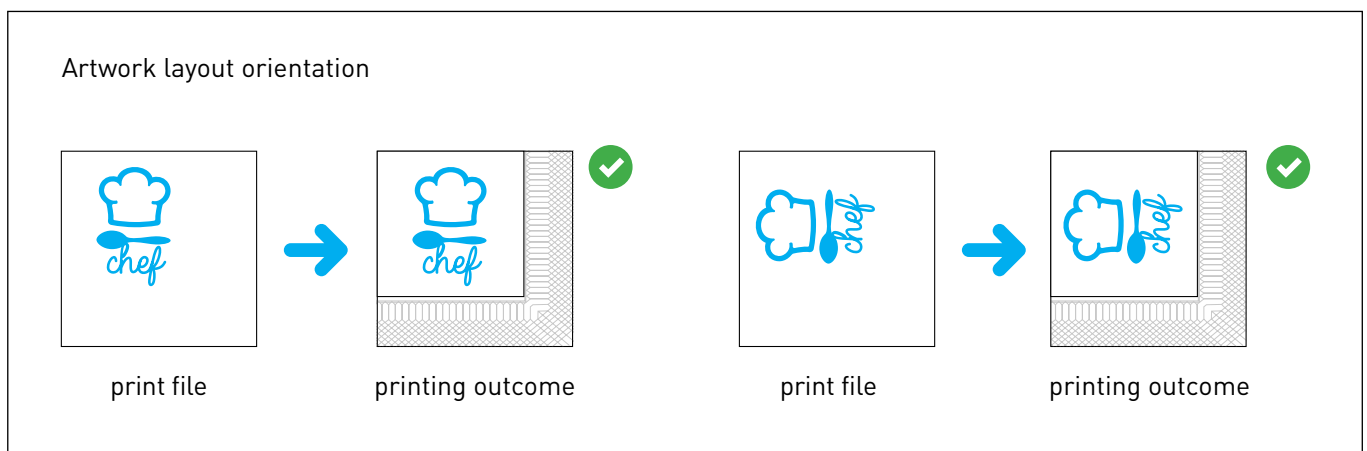

Printing of shades or screening is not possible.

Fonts in positives must be bigger than 9pt, and in negatives bigger than 14pt. If you are using script fonts make sure that they are not too slim nor smaller than 13pt (in positives) or 15pt (in negatives).

The **minimum printable areas** is 0,12pt, but keep in mind the cellulose colour absorbance, especially in texts and graphics in negatives. The grid bellow shows how much the a printed area may overflow due to colour absorbance effect. For the best results simple graphics are advisable, preferably vectoral.

Examples of printed characters, symbols and lines

Pt 8,2 ESEMPI DI VARI CARATTERI E MISURE
Esempi di Vari Caratteri e Misure
ESEMPI DI VARI CARATTERI E MISURE
Esempi di Vari Caratteri e Misure

Pt 9,5 ESEMPI DI VARI CARATTERI E MISURE
Esempi di Vari Caratteri e Misure
ESEMPI DI VARI CARATTERI E MISURE
Esempi di Vari Caratteri e Misure

Pt 11 ESEMPI DI VARI CARATTERI E MISURE
Esempi di Vari Caratteri e Misure
ESEMPI DI VARI CARATTERI E MISURE
Esempi di Vari Caratteri e Misure

Pt 13 ESEMPI DI VARI CARATTERI E MISURE
Esempi di Vari Caratteri e Misure
Esempi di Vari Caratteri e Misure
ESEMPI DI VARI CARATTERI E MISURE
Esempi di Vari Caratteri e Misure
Esempi di Vari Caratteri e Misure

mm
3
2,9
2,8
2,7
2,6
2,5
2,4
2,3
2,2
2,1
2
1,9
1,8
1,7
1,6
1,5
1,4
1,3
1,2
1,1
1
0,9
0,8
0,7
0,6
0,5
0,4
0,3
0,2
0,12

☼ ☼ ☼ ☼ ☼ ☼ ☼ ☼ ☼ ☼ ☼ ☼
☼ ☼ ☼ ☼ ☼ ☼ ☼ ☼ ☼ ☼ ☼ ☼
☼ ☼ ☼ ☼ ☼ ☼ ☼ ☼ ☼ ☼ ☼ ☼
☼ ☼ ☼ ☼ ☼ ☼ ☼ ☼ ☼ ☼ ☼ ☼

★ ★ ☀ ☀
★ ★ ☀ ☀
★ ★ ☀ ☀
★ ★ ☀ ☀
★ ★ ☀ ☀

5 TEMPLATE

To achieve the correct print, download the template from the web site, customise it with the desired artwork and save it in a PDF file.

6 PRINTING AREA

Position your graphic as you desire within the printing area, and assign a black colour to it (only K 100%). Napkins will be printed in the colour chosen by you in the order. (Burgundy, azure-blue, green, gray, black or mustard).

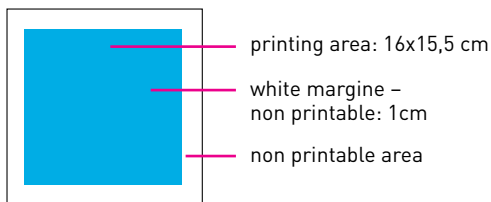

finished size - air-laid: 20x20 cm
(aperto 40x40 cm)

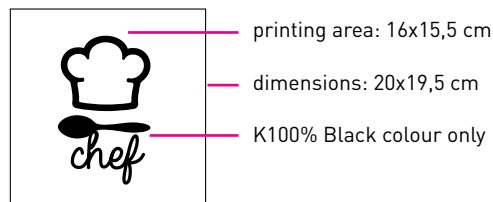

print file

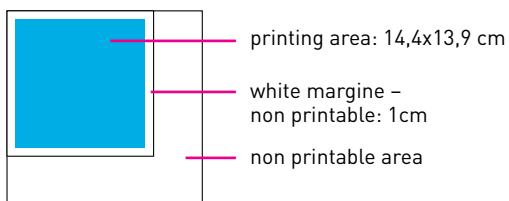

finished size - tissue: 20x20 cm
(flat size 40x40 cm)

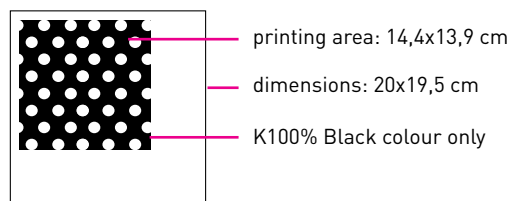

print file

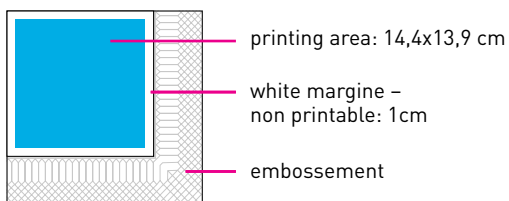

finished size - tissue: 16,5x16,5 cm
(flat size 33x33 cm)

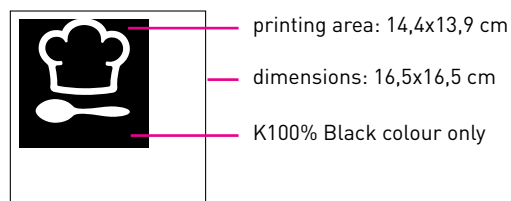

print file

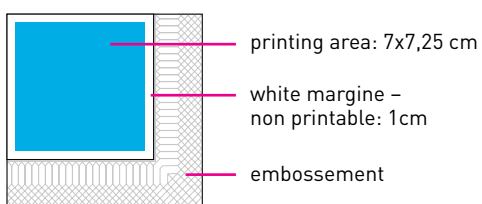

finished size - tissue: 12,5x12,5 cm
(flat size 25x25 cm)

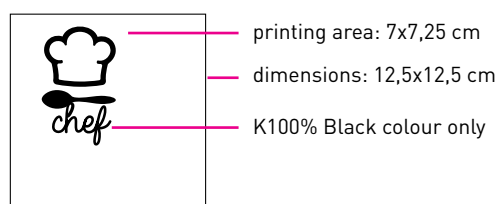

print file